



# Active L1 GPS / Passive Iridium Antenna

## P/N: 42GL1IR-AP-16TT-1 (with 16in TNC Male Cables, White)

Arinc 743 Configuration. Other Frequencies, Colors, Connectors and Connector Locations are Available



ISO 9001:2008/FAA Approved Facility

Antenna Mounts: <http://www.antcom.com/documents/catalogs/PeripheralAntennaProducts2.pdf>

ANTCOM CORPORATION . 367 Van Ness Way, Suite 602 . Torrance, CA 90501, USA . Tel: (310) 782-1076 . Fax: (310) 782-1086 . E-mail: [antennas@antcom.com](mailto:antennas@antcom.com) . <http://www.antcom.com>

**NOTICE OF PROPRIETARY RIGHTS**  
THIS DOCUMENT CONTAINS UNCLASSIFIED INFORMATION. IT IS THE PROPERTY OF ANTCOM CORPORATION. IT IS TO BE USED ONLY AS AUTHORIZED BY ANTCOM CORPORATION. IT IS TO BE KEPT IN CONFIDENTIALITY AND NOT TO BE DISCLOSED TO THE PUBLIC OR TO OTHERS WITHOUT THE WRITTEN CONSENT OF ANTCOM CORPORATION.

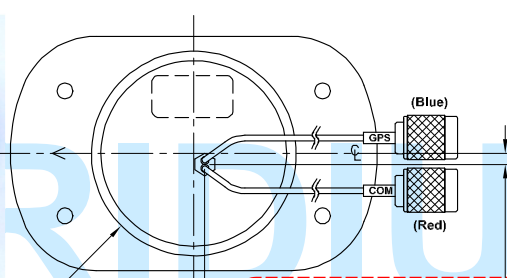
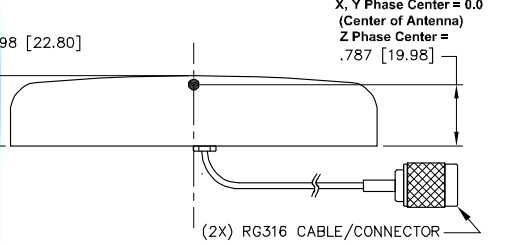
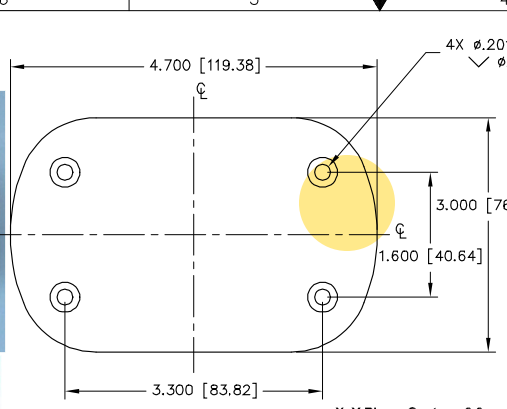
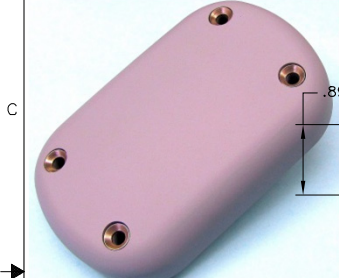

Y = 0	Y = 0	Y = 0
X = -.200 [5.07]	X = -.610 [15.48]	X = 0

### SPECIFICATIONS

ZONE	REV	REVISIONS		
		DESCRIPTION	DATE	APPROVED

### ELECTRICAL:

	IRIDIUM	GPS
FREQUENCY:	(1610.0 - 1626.5) MHz	L1: (1575.42 ±13)
RADIATION PATTERN:	HEMISPHERICAL	HEMISPHERICAL
POLARIZATION:	RHCP	RHCP
VSWR:	< 2.0:1	< 1.5:1
GAIN (dB):	4 ft G.P., Free Space	F.S., 4 ft G.P
@ 90° (Zenith):	+4.9	+5.0
@ 10° Elevation:	-1.0	-2.5
@ 20° Elevation:	+1.5	-0.5
@ 30° Elevation:	+2.4	+1.0
@ 60° to 90° Elevation:	>+3.3	>+2.7
BEAM WIDTH (3dB):	129°	96°-106°
AXIAL RATIO @ Zenith:	2 dB	2 dB
POWER HANDLING:	30 W	1 Watt
LIGHTNING PROTECTION:	DC GROUNDING	DC GROUNDING
FILTER (REJ. @1616 MHz):		> 60 dB
LNA GAIN:	N/A	(33.0±1.0) dB
LNA P 1dB Out:	N/A	+16 dBm
LNA NOISE FIGURE:	N/A	2.8 dB (Filter loss is Included)
VOLTAGE/CURRENT:	N/A	(+2.8 TO +28) Volts DC / (30 TO 50) mA

### MECHANICAL:

**SIZE:** 4.70 in. [119.4mm] X 3.00 in. [76.2 mm]  
**HEIGHT:** .898 in [22.80 mm]  
**WEIGHT:** 11.6 oz. (328.8 g)  
**FINISH:** SKYDROL RESISTANT POLYURETHANE ENAMEL BASE IRIDITE PER MIL-C-5541F CLASS 3  
**MATERIAL:** 6061-T6 ALUMINUM ALLOY BASE COMPOSITE RADOME, IMPACT, ABRASION, UV, SOLVENT, SKYDROL RESISTANCE, AND FIRE RETARDANT  
**CONNECTOR:** (2X) RG316 CABLE/ TNC CONNECTOR (OPTION: SMA, QMA, MCX, MMCX, N)

### ENVIRONMENTAL:

**TEMPERATURE:** -67 °F TO +185 °F [-55 °C TO +85 °C]  
 70,000 ft.  
**VIBRATION:** > 30 G's  
 HERMETICALLY SEAL

### FEDERAL & MILITARY SPECIFICATIONS:

FAA TSO-C144, DO-160D, D0-228, MIL-C-5541, MIL-E-5400, MIL-I-45208A, MIL-STD-810, AND SAE J1455

### ACCEPTANCE TEST PROCEDURE:

ATP-GPS-L1L2-100

QUANTITY	DESCRIPTION	PART NO	FINISH	NEW
4	Mounting Screw: 10-32, 2.0"	MS24693C284	-	3
1	O-Ring or Gasket	2-142/N756-75, Item 551t	-	2
				1

CONFIGURATION:	FREQ. BAND:	GPS/IRIDIUM LNA:	CABLE'S LENGTH:	MALE CONNECTOR:	COLOR:
1: 2" SO. (FLAT)	L1IR: L1 GPS & IRIDIUM	A: WITH LNA	I: NO CABLE	S: SMA; P: PINN	-1: GLOSS WHITE #17925 PER FED-STD-595B
1.5: 1.9" SO. (FLAT)	1216; L1/L2 GPS	P: WITHOUT LNA	M: WITH MAG. MOUNT	M: MCX; MM; MMCX	-2: LUSTERLESS GRAY #36320 PER FED-STD-595B
2: 2.6" DIA. (FLAT)			#: CABLE LENGTH (IN)	N: N; NB: Bulkhead	-3: CAMO GREEN #34094 PER FED-STD-595B
3: 3.5" DIA. (FLAT)			R: RIGHT ANGLE CON.	T: TNC; TB: TNC- Bulkhead	-4: LUSTERLESS BLACK #37038 PER FED-STD-595B
4: MINI ARINC (FLAT)					-5: DESERT TAN #33446 PER FED-STD-595B
53: (HELIX ROD)					
5B: (HELIX BLADE)					
3D: (HELIX HANDHELD)					

P/N: 42GL1IR-AP-XTT-X-X

UNLESS OTHERWISE SPECIFIED DIMENSIONS ARE IN INCHES FRACTIONS SHOULD BE ANGLES ± 1/64 DECIMAL ± .010  
 TOLERANCE .5% PER ANSI Y14.5  
 BREAK EXTERNAL EDGES .008 TO .015  
 SURF. FINISH PER MIL-C-26000  
 DIM'S ON A DIMENSION ± .005  
 MACHINED SURFACES  
 DO NOT SCALE DRAWING

**ANTCOM CORP.** TORRANCE, CALIFORNIA  
 FLAT FIXED MOUNT  
 ACTIVE L1 GPS/IRIDIUM  
 ANTENNA

DATE: 3CVE1  
 P/N: 42GL1IR-AP-XTT-X-X  
 SCALE: 1/1  
 SHEET: 1 OF 1

NMO Connector is Now Available for Some Antennas